

W 61809-2RS1 Deep groove ball bearings

Deep groove ball bearings

Bearing data

[Tolerances](#),

Normal (metric), P6, P5, Normal (inch),

[Radial internal clearance](#),

Matched bearing pairs, Stainless steel
 $d < 10$ mm, Other bearings

Bearing interfaces

[Seat tolerances for standard conditions](#),

[Tolerances and resultant fits](#)

Technical specification

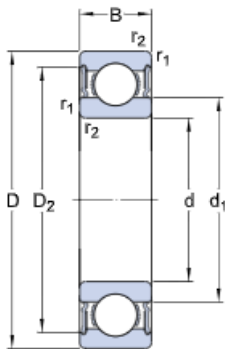

DIMENSIONS

d	45 mm	Bore diameter
D	58 mm	Outside diameter
B	7 mm	Width
d_1	≈ 48.2 mm	Shoulder diameter
d_2	≈ 48.2 mm	Recess diameter
D_2	≈ 54.9 mm	Recess diameter
$r_{1,2}$	min. 0.3 mm	Chamfer dimension

ABUTMENT DIMENSIONS

d_{ξ} min.	47 mm	Diameter of shaft abutment
d_{ξ} max.	48 mm	Diameter of shaft abutment
D_i max.	56 mm	Diameter of housing abutment
r_a max.	0.3 mm	Radius of shaft or housing fillet

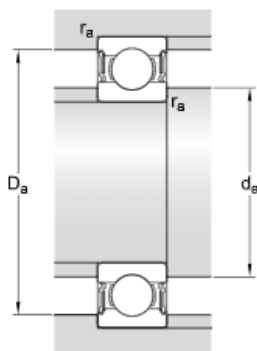

CALCULATION DATA

C	4.94 kN	Basic dynamic load rating
C ₀	5 kN	Basic static load rating
P _u	0.212 kN	Fatigue load limit
	6 700 r/min	Limiting speed
k _r	0.02	Minimum load factor
f ₀	15.1	Calculation factor

MASS

	0.037 kg	Mass bearing
--	----------	--------------

TOLERANCE CLASS

Normal	Dimensional tolerances
Normal	Radial run-out